



OFFERS IN EXCESS OF £130,000

15 STEPNEY AVENUE, SCARBOROUGH, YO12 5BW

- Sought After Location
- Two Bedrooms
- Two Reception Rooms
- Gas Central Heating

FIRST TIME BUYERS, THIS IS THE ONE! SITUATED ON THIS SOUGHT-AFTER STREET, CLOSE TO THE TOWN CENTRE IS THIS TWO BEDROOM MID TERRACED HOUSE WHICH REQUIRES A LITTLE BIT OF LOVE TO CREATE A SUPERB PROPERTY. TWO DOUBLE BEDROOMS, TWO RECEPTION ROOMS, WHITE BATHROOM SUITE, KITCHEN AND ENCLOSED REAR YARD.



TIPPLE UNDERWOOD ESTATE
AGENTS

3 Coldyhill Lane, Scarborough, North
Yorkshire, YO12 6SF

CONTACT

www.tippleunderwood.co.uk

01723 350299

mail@tippleunderwood.co.uk

Agents Note: Whilst every care has been taken to prepare these sales particulars, they are for guidance purposes only. All measurements are approximate and for general guidance purposes only and whilst every care has been taken to ensure their accuracy, they should not be relied upon and potential buyers are advised to recheck the measurements

GROUND FLOOR
355 sq.ft. (33.0 sq.m.) approx.

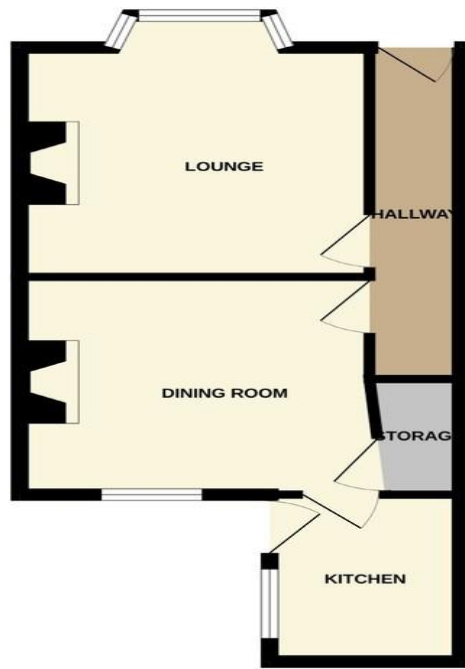

1ST FLOOR
347 sq.ft. (32.2 sq.m.) approx.



TOTAL FLOOR AREA: 702 sq.ft. (65.2 sq.m.) approx.
Whilst every attempt has been made to ensure the accuracy of the description contained here, measurements of floors, windows, rooms and any other items are approximate and no responsibility is taken for any error, omission or mis-statement. This plan is for illustrative purposes only and should be used as such by any prospective purchaser. The services, systems and appliances shown have not been tested and no guarantee as to their operability or efficiency can be given.
Made with Metropix ©2023

Property Description

The property when briefly described comprises entrance hall, bay fronted lounge, rear facing dining room and kitchen to the ground floor. On the first floor are two well-appointed bedrooms and a white bathroom suite. Enclosed yard to the rear with two outhouses. The property has upvc double glazing and gas central heating.



GROUND FLOOR

ENTRANCE HALL

LOUNGE
11' 9" x 11' 8" (3.58m x 3.56m) into bay

DINING ROOM
12' 4" x 10' 5" (3.76m x 3.18m)

KITCHEN
7' 10" x 5' 9" (2.39m x 1.75m)

FIRST FLOOR

LANDING

BEDROOM
15' 2" x 10' (4.62m x 3.05m)

BEDROOM
10' 6" x 9' 6" (3.2m x 2.9m)

BATHROOM
7' 5" x 5' 8" (2.26m x 1.73m)

OUTSIDE

REAR YARD

