



Score	Energy rating	Current	Potential
92+	A		
81-91	B		
69-80	C		72 C
55-68	D	63 D	
39-54	E		
21-38	F		
1-20	G		



£320,000

2 NORTHFIELD WAY, SCALBY, SCARBOROUGH, YO13 0PW

- Detached House
- Four Bedroom
- Double Garage
- Gardens

A FOUR DOUBLE BEDROOM DETACHED HOUSE ON THIS PLEASANT CUL DE SAC IN THE POPULAR NORTH SIDE VILLAGE OF SCALBY. THE PROPERTY WHICH NEEDS SOME UPDATING AND IMPROVEMENT WILL MAKE A LOVELY FAMILY HOME IN A GREAT LOCATION.



TIPPLE UNDERWOOD ESTATE AGENTS
3 Coldyhill Lane, Scarborough, North Yorkshire, YO12 6SF

CONTACT
www.tippleunderwood.co.uk
01723 350299
mail@tippleunderwood.co.uk

Agents Note: Whilst every care has been taken to prepare these sales particulars, they are for guidance purposes only. All measurements are approximate and for general guidance purposes only and whilst every care has been taken to ensure their accuracy, they should not be relied upon and potential buyers are advised to recheck the measurements.

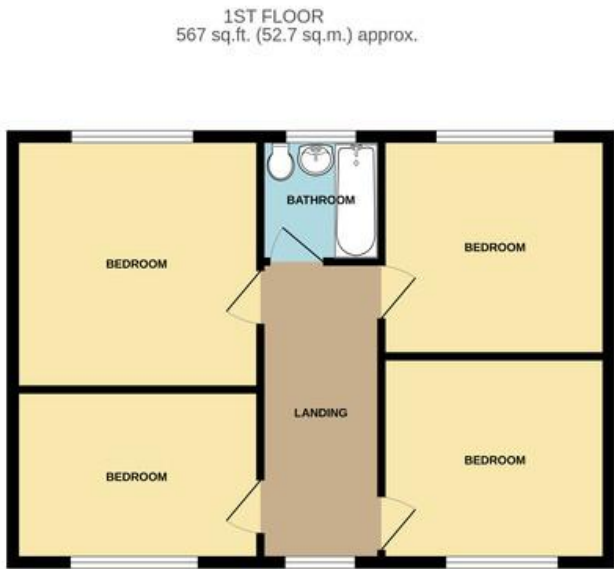

TOTAL FLOOR AREA : 1138 sq.ft. (105.7 sq.m.) approx.
Whilst every attempt has been made to ensure the accuracy of the floorplan contained here, measurements of doors, windows, rooms and any other items are approximate and no responsibility is taken for any error, omission or mis-statement. This plan is for illustrative purposes only and should be used as such by any prospective purchaser. The services, systems and appliances shown have not been tested and no guarantee as to their operability or efficiency can be given.
Made with Metropix ©2025



Property Description

Offered to the market with no onward chain this detached house when briefly described comprises entrance hall, dual aspect lounge, separate dining room, kitchen and downstairs w/c to the ground floor. On the first floor are four double bedrooms and the main bathroom. Enclosed garden to the rear mainly laid to lawn and an attached double garage with recent new roof under guarantee.



GROUND FLOOR

ENTRANCE HALL

LOUNGE
20' 1" x 11' 9" (6.12m x 3.58m)

DINING ROOM
10' 9" x 9' 9" (3.28m x 2.97m)

KITCHEN
10' 9" x 10' 5" (3.28m x 3.18m)

WC

FIRST FLOOR

LANDING

BEDROOM
11' 9" x 11' 10" (3.58m x 3.61m)

BEDROOM
12' x 9' 9" (3.66m x 2.97m)

BEDROOM
11' 9" x 8' 5" (3.58m x 2.57m)

BEDROOM
10' 9" x 8' 5" (3.28m x 2.57m)

BATHROOM

OUTSIDE

GARDENS

DOUBLE GARAGE